

Powerlink Switch

OneRemote Type 30012642

User Manual



Content

Basic Application 3
 Plug & Play 3
Installation 4
Special Applications with an IR-receiver Connected 5
Option Programming 6

Basic Application

The OneRemote PowerLink Switch is developed for use with active (powered) B&O speakers connected with PowerLink DIN cables.

A PowerLink Switch makes it possible for two different sound sources, to share one set of active PowerLink speakers.

An example:

- BeoSound 5 Encore. (B&O Standalone audio product.)
- BeoVision TV
- One set of active B&O speakers

Plug & Play

The Powerlink Switch can be programmed for use in special setups. In these cases the selected source is determined by a IR-receiver that detects signals directly from the B&O remote control. See following chapters about special use.

Factory setting of the Powerlink Switch is option-2, therefore the function is:

Source 1	Source 2	Output
ON	OFF	Source 1
ON	ON	Source 2
OFF	ON	Source 2
OFF	OFF	Speaker off

This PowerLink Switch may be programmed for special applications, when an IR-receiver is attached. Note that the IR-receiver is not included as a standard delivery.

Installation

The OneRemote PowerLink Switch is easily installed.

1. Connect the speakers with PowerLink cable(s). *Not included.*
2. Connect the two sound sources with PowerLink cables. *Not included.*
3. Connect the mains adaptor.

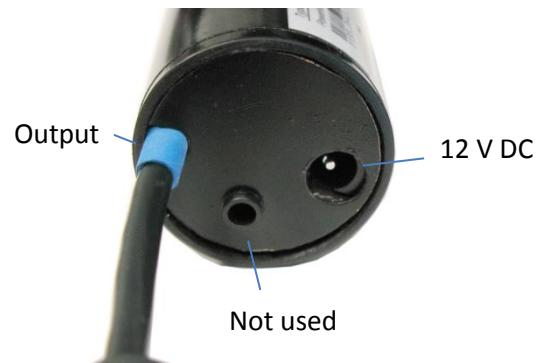
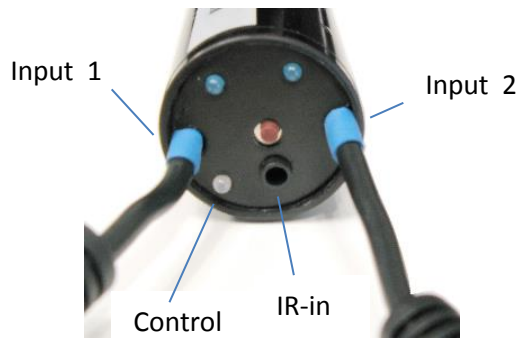

No programming is required for the basic application.

Special Applications with an IR-receiver Connected

The main application for this PowerLink Switch is enabling the alternating use of just one set of active speakers for two separate B&O sound sources.

As a default setting the switch detects whenever one of the two sources is powered up, and then directs the signal from this source to the speakers which are powered up simultaneously.

For other special applications the PowerLink Switch can be option-programmed, using an external IR-receiver.

Basically the PowerLink Switch operates in one of three ways:

- **Switching via IR-control only.**
- **Switching to last source powered up.
Switching via IR-control too, if an IR-receiver is connected.**
- **Switching to source B, if source B is powered up, otherwise source A is selected. (Stop – 2 option).
Switching via IR-control too, if an IR-receiver is connected.**

Option Programming

The PowerLink Switch may be programmed with different options, determining the way the switching is done. Programming is made only once, during the initial installation.

Programming an option is easy. Programming is carried out using the Bang & Olufsen remote control. Therefore an IR-receiver is required to be connected to the PowerLink Switch during programming.

Press and hold the programming switch on the PowerLink Switch till the Status LED turns red.

Then press a 2 key option code on your Bang & Olufsen remote control within 30 seconds. The Status LED is acknowledging the input by flashing green.

The 2 key options are found in the tables below.

Status LED During Option Programming	
Red	The programming switch has been activated for more than two seconds, and the PowerLink Switch is in the option programming mode. When in the programming mode the 2 key option code must be entered within 30 seconds.
Flashing Green	An option has been entered correctly.
Flashing Red	An error occurred while entering an option. No changes have been made.
Green	Idle, more than 30 seconds passed without receiving data.

2-Key Option Table	
STOP 0	Sound source selection is controlled only via an external IR-receiver. Any source key may be used to select one of the two sources. Refer to the IR-source option table below for these options.
STOP 1	When one of the two sources is powered up, the switch directs this sound signal to the speakers.
STOP 2	If the source connected to input 2 is powered up, the switch directs the sound signal from it to the speakers, otherwise the sound signal from input 1 is selected.

2-Key IR-source Selection Table			
Examples of options for source selection using an IR-receiver.			
VAUX	0	VAUX	will be ignored.
VAUX	1	VAUX	will select input 1.
VAUX	2	VAUX	will select input 2.
VTAPE	0	VTAPE	will be ignored.
VTAPE	1	VTAPE	will select input 1.
VTAPE	2	VTAPE	will select input 2.
AMEM	1	AMEM	will select input 1.
RADIO	2	RADIO	will select input 2.
... and so on. Any source key can be programmed to select one of the two inputs.			
An option must be entered for every source key used in the set-up.			

Specifications

Included with this PowerLink Switch:

Power Adaptor: 12VDC @ 400mA

Not included with the PowerLink Switch:

IR-receiver 455 KHz
Cables

Sockets:

Input 1: DIN 8-pin PowerLink
 Input 2: DIN 8-pin PowerLink
 Output: DIN 8-pin PowerLink

 IR Input: Jack 3-conductor, 5 volt
 IR output: Jack 3-conductor, not used.

